

Thread 2 Piece Floating Full Bore Ball Valves
Thread 2 Piece Floating Reduced Bore Ball Valves



DN 15-50 PN 10-63 /WOG1000

- Final inspection and test according to: ISO 5208, DIN EN 12266, API 598
- Thread ends according to ISO 7-1 (EN 10226-1).
- Coating: Epoxy Powder Paint with Electrostatic Process-RAL 5005
- Direct Mount Actuator according to ISO5211
- Available Material:
 - Body: CF8M, CF8, ASTM A216WCB
 - Ball: AISI420, AISI304, AISI316, CF8M, CF8, Duplex
 - Shaft: AISI420, AISI304, AISI316, Duplex
 - Sealing: PTFE, RPTFE, NBR, EPDM, Silicon, Viton
 - Seat: AISI420, AISI304, AISI316, CF8M, CF8, Duplex

**Valves with special material are manufactured according to customer requirement.

Threaded 2 Piece Floating Full & Reduced Bore Ball Valves DN 15-50 PN10-63/ WOG1000

PN	Hydrostatic test pressure in bar with water		
	shell	high pressure closure	low pressure closure
10	15	11	4 to 7
16	24	18	4 to 7
25	38	28	4 to 7
40	60	44	4 to 7
63	95	70	4 to 7

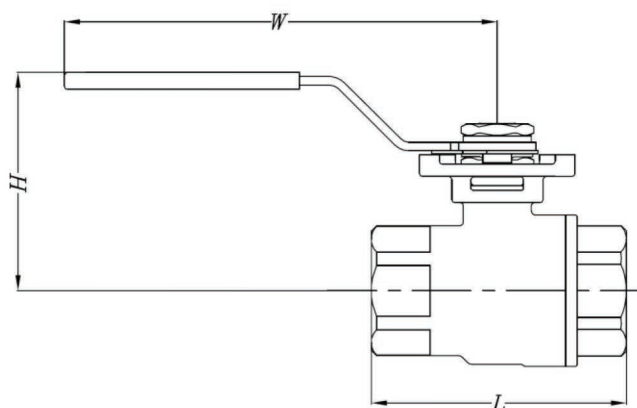

DN	L [mm]	H [mm]	W [mm]	Weight [kg]
15	55	62	112	0.4
20	70.5	69	140	0.6
25	83	71	140	0.8
32	91	87	175	1.4
40	103	93	220	2.0
50	120	107	220	2.9