

**Socket Weld 3 Piece Floating Full Bore Ball Valves-WOG1000**

**Thread 3 Piece Floating Full Bore Ball Valves-WOG1000**

**Socket Weld 3 Piece Floating Reduced Bore Ball Valves-WOG1000**

**Thread 3 Piece Floating Reduced Bore Ball Valves-WOG1000**



**DN 15-50 PN 10-63 / WOG1000**

- Final inspection and test according to: ISO 5208, DIN EN 12266, API 598
- Thread ends according to ISO 7-1 (EN 10226-1).
- Coating: Epoxy Powder Paint with Electrostatic Process-RAL 5005
- Direct Mount Actuator according to ISO5211
- Available Material:
  - Body: CF8M, CF8, ASTM A216WCB
  - Ball: AISI420, AISI304, AISI316, CF8M, CF8, Duplex
  - Shaft: AISI420, AISI304, AISI316, Duplex
  - Sealing: PTFE, RPTFE, NBR, EPDM, Silicon, Viton
  - Seat: AISI420, AISI304, AISI316, CF8M, CF8, Duplex

**\*\*Valves with special material are manufactured according to customer requirement.**

Socket Weld 3 Piece Floating Full & Reduced Bore Ball Valves DN 15-50 PN10-63/ WOG1000

PN	Hydrostatic test pressure in bar with water		
	shell	high pressure closure	low pressure closure
10	15	11	4 to 7
16	24	18	4 to 7
25	38	28	4 to 7
40	60	44	4 to 7
63	95	70	4 to 7

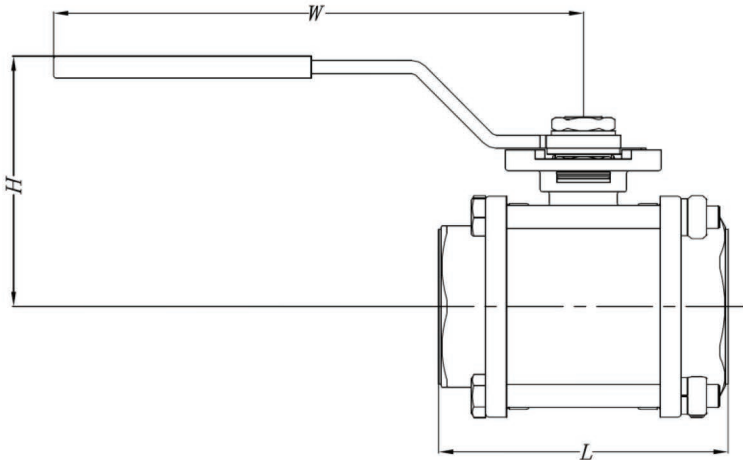

DN	L [mm]	H [mm]	W [mm]	Weight [kg]
15	55	62	112	0.45
20	73	69	140	0.85
25	81	71	140	1.1
32	91	87	175	1.8
40	103	93	220	2.5
50	120	107	220	3.5

## Threaded 3 Piece Floating Full & Reduced Bore Ball Valves DN 15-50 PN10-63/ WOG1000

PN	Hydrostatic test pressure in bar with water		
	shell	high pressure closure	low pressure closure
10	15	11	4 to 7
16	24	18	4 to 7
25	38	28	4 to 7
40	60	44	4 to 7
63	95	70	4 to 7

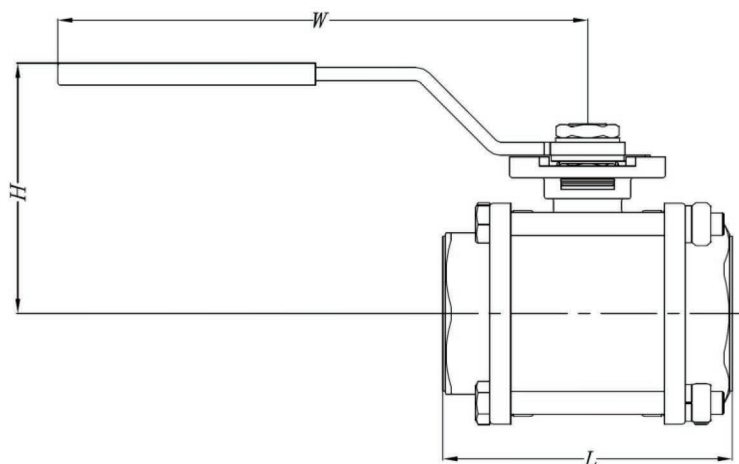

DN	L [mm]	H [mm]	W [mm]	Weight [kg]
15	55	62	112	0.45
20	73	69	140	0.85
25	81	71	140	1.1
32	91	87	175	1.8
40	103	93	220	2.5
50	120	107	220	3.5