

Dual Plate Check Valves



Wafer Type Dual Plate Check Valves

DN 50-700 PN 10-25/ Class 150



Flanged Type Dual Plate Check Valves

DN 50-700 PN 10-25/ Class 150



Lug Type Dual Plate Check Valves

DN 50-700 PN 10-25/ Class 150

- Design according to: API 594
- Flange connection according to: ISO 7005-2, DIN EN 1092-2, ASME B16.5 & B16.47
- Face to face dimension according to: ASME B16.10
- Final inspection and test according to: ISO 5208 (DIN EN 12266), API 598
- Coating: Epoxy powder paint with electrostatic process-RAL 5005
- Available Material:
 - Body: EN GJS 400-15, ASTM A216-WCB, ASTM B148 (C95800), CF8M
 - Disk: CF8, CF8M, ASTM B148 (C95800)
 - Shaft: AISI 420, AISI 304, AISI 316, Duplex, Monel
 - Sealing: EPDM, NBR, Silicon, Viton
 - Spring: AISI 302, Inconel X750

**Valves with special material are manufactured according to customer requirement.

Dual Plate Check Valves -Wafer Type

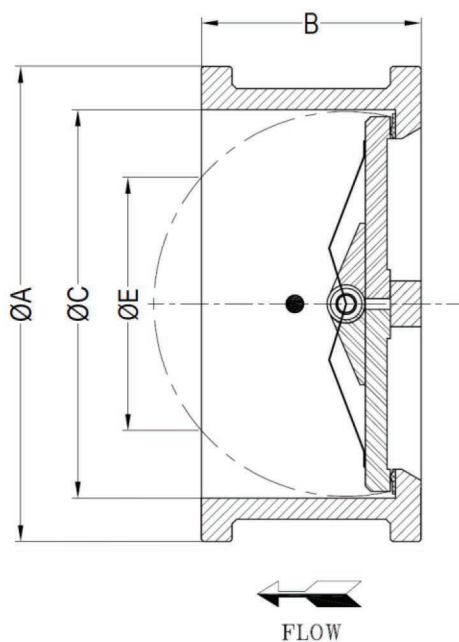

DN (mm)	ØA (mm)		B (mm)	ØC (mm)	ØE (mm)	Weight (Kg)
	PN 10,16	Class 150				
50	105	105	60	61	0	3
65	124	124	67	73	32	4.5
80	137	137	73	89	51	5
100	162	175	73	114	85	6
125	192	197	86	141	112	12
150	218	222	98	168	141	15
200	273	279	127	219	171	26
250	328	340	146	273	229	44
300	380	410	181	324	252	60
350	440	451	184	356	308	100
400	490	514	191	406	331	115
450	545	549	203	457	405	140
500	591	606	219	508	452	192
600	700	718	222	610	552	235
700	810	832	381	711	648	480

Dual Plate Check Valves-Flanged Type

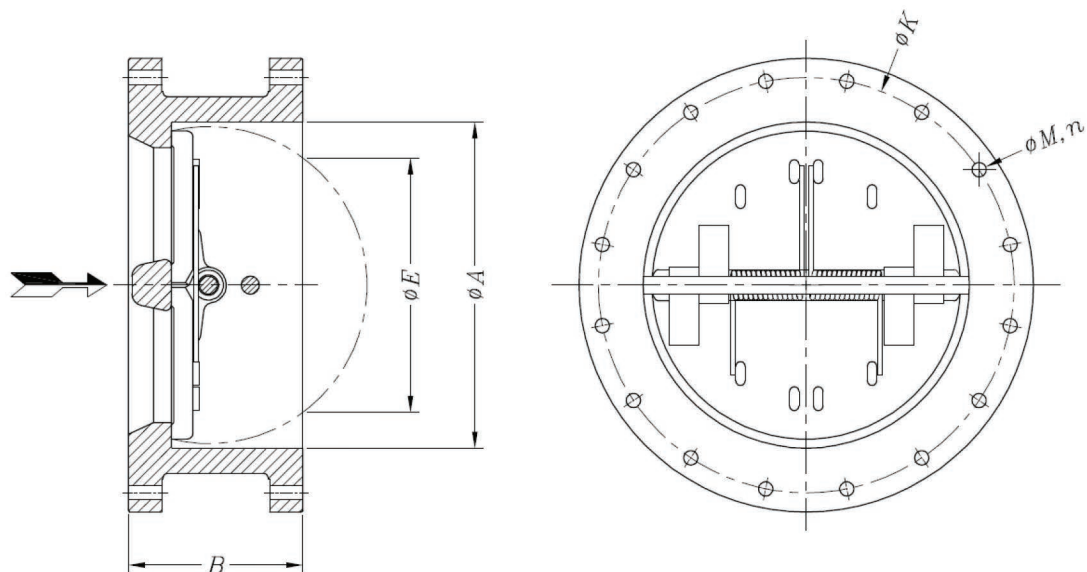

DN (mm)	ØA (mm)	ØE (mm)	B (mm)	ØM (mm)				n				ØK (mm)			
				PN10	PN16	PN25	Class 150	PN10	PN16	PN25	Class 150	PN10	PN16	PN25	Class 150
300	327	225	181	23	28	31	25	12	12	16	12	400	410	430	432
350	356	300	184	23	28	34	29	16	16	16	12	460	470	490	476
400	406	351	191	28	31	37	29	16	16	16	16	515	525	550	540
450	450	391	203	28	31	37	32	20	20	20	16	565	585	600	578
500	498	439	219	28	34	37	32	20	20	20	20	620	650	660	635
600	610	557	222	31	37	40	35	20	20	20	20	725	770	770	750
700	711	457	381	31	37	43	35	24	24	24	28	840	840	875	864

Weight (Kg)							
DN (mm)	300	350	400	450	500	600	700
PN10-16	95	115	145	175	228	335	650
PN125 Class 150	100	123	154	186	237	345	680

Dual Plate Check Valves-Lug Type

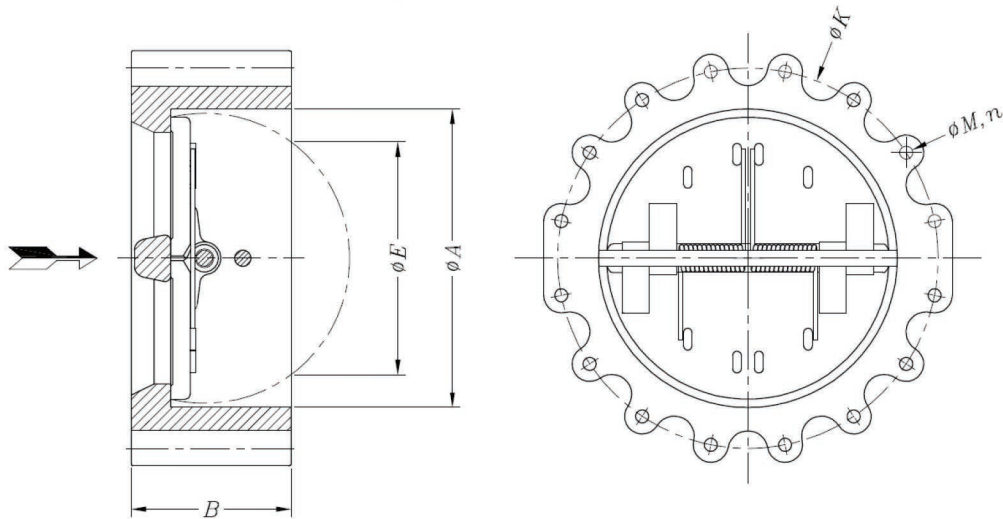

DN (mm)	ØA (mm)	ØE (mm)	B (mm)	ØM (mm)				n				ØK (mm)			
				PN10	PN16	PN25	Class 150	PN10	PN16	PN25	Class 150	PN10	PN16	PN25	Class 150
50	61	7	60	M16	M16	M16	M16	4	4	4	4	125	125	125	120.5
65	73	18	67	M16	M16	M16	M16	4	4	8	4	145	145	145	139.5
80	92	51	73	M16	M16	M16	M16	8	8	8	4	160	160	160	152.5
100	117	90	73	M16	M16	M20	M16	8	8	8	8	180	180	190	190.5
125	141	110	86	M16	M16	M24	M20	8	8	8	8	210	210	220	216
150	168	127	98	M20	M20	M24	M20	8	8	8	8	240	240	250	241.5
200	219	161	127	M20	M20	M24	M20	8	12	12	8	295	295	310	298.5
250	273	218	146	M20	M24	M27	M22	12	12	12	12	350	355	370	362
300	327	225	181	M20	M24	M27	M22	12	12	16	12	400	410	430	432
350	356	300	184	M20	M24	M30	M27	16	16	16	12	460	470	490	476
400	406	351	191	M24	M27	M33	M24	16	16	16	16	515	525	550	540
450	450	391	203	M24	M27	M33	M30	20	20	20	16	565	585	600	578
500	498	439	219	M24	M30	M33	M30	20	20	20	20	620	650	660	635
600	610	557	222	M27	M33	M36	M33	20	20	20	20	725	770	770	750
700	711	457	381	M27	M33	M39	M33	24	24	24	28	840	840	875	864

Weight (Kg)															
DN (mm)	50	65	80	100	125	150	200	250	300	350	400	450	500	600	700
PN10-16	4	6	8	12	16	19	38	65	110	135	182	210	298	360	835
PN125-Class 150	4	6	8	13	18	21	41	69	115	140	190	220	310	370	850